

---

## CURRICULUM VITAE

---

### **EMAN BAHHO**

(Senior Engineer  
Structural)

date of birth  
**3<sup>rd</sup> August 1960**

nationality  
**new zealand**

education  
**university of technology  
baghdad**

qualifications  
**bachelor of civil engineering  
GIPENZ**

**Chartered Engineer  
project management and  
planning certificate**

areas of expertise  
**structural design  
planning  
project management  
CAD draughting**

#### **Feb 2008 - Present Strata Group Consulting Engineers Ltd Senior Engineer**

Responsibilities include structural design, contract documentation, project management, construction supervision & site investigations

#### **2001-2008 BHC Consulting Ltd Structural Engineer**

Responsibilities include structural design, project management, construction supervision & site investigations

#### **2000-2001 LHT Consulting Engineers Structural Draughtsperson**

Involved in preparing structural drawings for projects

#### **1997-2000 Eastbridge Ltd Structural Draughtsperson**

Responsibilities included preparation of shop drawings for communication towers.

#### **1987-1994 Al-Mansour Contracting Company Planning Engineer**

Responsible for programming and reporting on large projects using critical path analysis.

#### **1985-1987 Industrial Projects Contracting Company Project Manager**

Responsibilities included Project Managing Site Supervision, and Contract Observation

### MAJOR PROJECTS

**Crown Hotel - Carpark**  
Construction of a 2 storied precast concrete carpark building  
Est Cost \$0.8 million

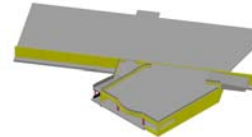

**Retail & Apartment Complex**  
Conversion of an existing woolstore to a 2 storied retail and apartment complex  
Est Cost 1.5 million



**Skins Dwelling**  
Structural Design of a luxury dwelling using Insulform Wall system  
Est Cost 2.0 million



**Marine View Apartments Car Park**  
5 Storey Apartment Block with swimming pool & paved garden on top plus 2 storey car park  
Est Cost \$6 million



**Gear Apartments**  
3 Story Apartments  
Est Cost \$2Million



**Young Nicks Head Bridge**  
Est Cost \$950,000

**Waioeka Domain Sports Ablution complex – Opotiki**  
**Precast Panel and Curved Steel Roof Structure**

**River Oak Mews Car Park**  
Steel and Concrete 2 storied carpark complex.  
Est Cost \$0.8 million

**80M Towers Puketiro Forest**  
**Lattice Steel Frame and concrete foundations modular structures**

**Mainfreight Workshop & Apartments**  
**Gisborne**  
2 Storied Masonry and Steel structures

**AllBrite Recycle Complex**  
**Gisborne**  
Concrete Tilt Slab and Steel Framed Structures

**Te Wananga O Aotearoa Gisborne Campus**  
Administration Entrance, Resource Centre, Class Rooms & Work Shop  
Architectural Tilt Slab and steel frame structures

**Barry Alan Suspended Swimming Pool**  
**Gisborne**  
Suspended residential pool supported off steel frames